

T-FIT[®] Clean

T-FIT Clean PVDF Foam Insulation
comparative performance data

T-FIT[®]

INSULATION

Fit to perform. Fit to last



T-FIT[®] Clean Insulation is manufactured from Zotefoams ZOTEK[®] F42 HT LS fine, closed cell foam, the only foam product to be specification tested to FM4910 Clean Room Materials Protocol.

Introduction

T-FIT[®] Clean consistently outperforms the competition in the most demanding cleanroom and manufacturing environments. Fire-retardant, moisture- and bacteria-resistant, T-FIT[®] Clean is the only insulation solution that complies with internationally-recognised cleanroom standards. The comparative data shown in the table below is based on readily available product information typically located on manufacturers websites.

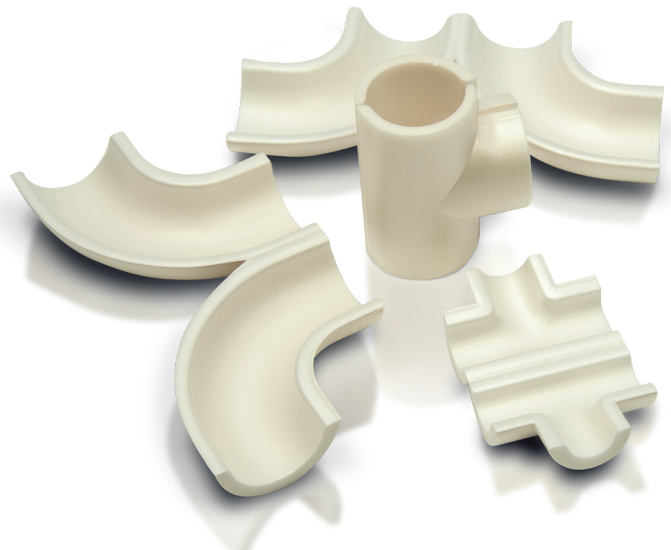

Melamine Foam Insulation

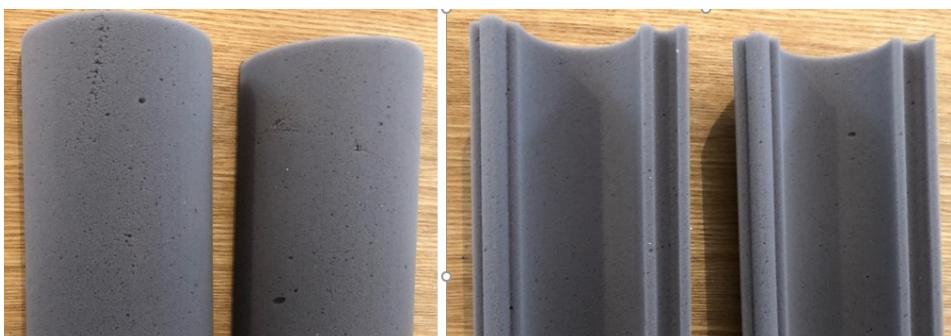

Pre-jacketed Melamine Foam Insulation

Feature	T-FIT Clean	Melamine Foam	Explanation
Base polymer	PVDF	Melamine	PVDF produced with zero FR/UV/ant-microbial additives, Melamine use of additives not known
Material Brand	ZOTEK F	Various	ZOTEK F produced by Zotefoams plc.
Structure	Closed Cell	Open cell	T-FIT fully closed cell, even if damaged
Jacket required	No	Yes	Melamine based product require outer jacket to prevent water/ vapour absorption
Minimum gauge	6.35mm -1/4"	25mm - 1"	By it's nature T-FIT can be supplied at 1/4"/6.35mm
E84 reaction to fire	0/0	25/50	This the standard used by UL to test to UL723
UL723	0/0	Test not found	UL independently test/verify result for T-FIT
FM4910	Yes	Test not found	Independent specification test by Factory Mutual of T-FIT Clean for use in clean rooms
Euroclass EN13501	B S1 D0	Test not found	B S1 D0 is the best result for a polymer insulation product
Thermal conductivity	0.0347	0.039	Expressed in W/m.K at 25°C, melamine 12.5% higher than T-FIT
Ease of installation	Easy/fast	Care/jacketing	Making sure outer cladding is sealed properly takes time and skill
System supply	Yes	No	T-FIT is supplied with elbows, tee's, insulation boxes, tape and adhesive
Density variation	+/- 15%	+/- 43%	Thermal performance must be impacted given a wide variance on melamine density
Particulates	No	Yes	Fume cupboard testing clearly shows no particulate release form T-FIT Clean
Surface voids	None	Yes	Melamine data sheet states "upper limit 10 voids per m ² , range 5 to 15mm"
VOC/AMC emissions	Very low	Test not found	Total VOC measurement 9 ug/g for ZOTEK F, outgassing from jacketing not found
Upper service temp	160°C/320°F peak	176°C/350°F	Melamine based on ASTM C356/1410 based on 24 hours testing only
Lower service temp	-80°C/-112°F	-40°C/-40°F	Informal testing indicates T-Fit Clean can operate at ~-195°C
Compression/ recovery	Excellent	Very Poor	T-FIT Clean is crosslinked, deformation of melamine can cause failure of cladding systemd
Resistance to fungal attack	None after 28 days	Test not found	According to ASTM G21 - 15, test data not found for jacketing
UV resistance	Very high	Test not found	PVDF is naturally UV resistant

Elastomeric Foam Insulation



Feature	T-FIT Clean	Elastomeric		Explanation
Base polymer	PVDF	NBR/PVC	EPDM	PVDF produced with zero FR/UV/ant-microbial additives
Material Brand	ZOTEK F	Various	Various	ZOTEK F produced by Zotefoams plc
Structure	Closed Cell	Closed cell	Closed cell	T-FIT fully closed cell, even if damaged
Minimum gauge	6.36mm - 1/4"	13mm - 1/2"	13mm - 1/2"	By it's nature T-FIT can be supplied at 1/4"/6.35mm, elastomeric generally 13mm - 1/2"
UL723/E84	0/0	Test not found	25/50	UL independently test/verify results of E84 testing
FM4910	Yes	Test not found	Test not found	Independent specification test by Factory Mutual of T-FIT Clean for use in clean rooms
Euroclass EN13501	B S1 D0	B S3 D0	D S3 D0	B S1 D0 is the best result for a polymer insulation product
Thermal conductivity	0.0314	0.033	0.041	Expressed in W/m.K at 0°C
Ease of installation	Easy/fast	Skills needed	Skills needed	Fittings need to be fabricated to install Elastomeric insulation
System supply	Yes	No	No	T-FIT Clean is supplied with elbows, tee's, insulation boxes, tape and adhesive
VOC/AMC emissions	17.95	280	352	Based on Exyte testing according to VDI 2083-P17, measured in ug/g
Upper service temp	160°C/320°F peak	110°C/230°F	125°C/257°F	Elastomeric data based on 72 hour test only
Lower service temp	-80°C/-112°F	-40°C/-40°F	-50°C/-58°F	Informal testing indicates T-FIT Clean can operate at ~-195°C
WVDR μ value	6,500	10,000	3,000	Water Vapour Diffusion Resistance measurement
Compression/recovery	Excellent	Poor	Poor	Crosslinked nature of T-FIT Clean prevents permanent deformation when compressed
Fungal resistance	None after 28 days	Test not found	Level 2 growth	According to ASTM G21 - 15
UV resistance	Very high	No	Yes	PVDF is naturally UV resistant

Stonewool HVAC Insulation



Feature	T-FIT Clean	Stonewool H&V	Explanation
Base polymer	PVDF	Stonewool fibres	PVDF produced with zero FR/UV/ant-microbial additives, Melamine use of additives not known
Material Brand	ZOTEK F	Various	ZOTEK F produced by Zotefoams plc.
Structure	Closed Cell	Open cell	T-FIT fully closed cell, even if damaged
Jacket required	No	Yes	Fibre based product require outer jacket to prevent water/vapour absorption
Minimum gauge	1/4"	20mm - 3/4"	By it's nature T-FIT can be supplied at 1/4"/6.35mm
UL723/E84 reaction to fire	0/0	Test not found	UL independently test/verify results of E84 testing
FM4910	Yes	Test not found	Independent specification test by Factory Mutual of T-FIT Clean for use in clean rooms
Thermal conductivity	0.032	0.033	Expressed in W/m.K at 10°C/50°F
Ease of installation	Easy/fast	Care/slow	Making sure outer cladding is sealed properly takes time and skill, fittings fabricated from straights
System supply	Yes	No	T-FIT is supplied with elbows, tee's, insulation boxes, tape and adhesive
Particulates	No	Yes	Fume cupboard testing clearly shows no particulate release form T-FIT Clean
VOC/AMC emissions	Very low	Not found	Total VOC measurement 9 ug/g for ZOTEK F, outgassing from jacketing not found
Upper service temp	160°C/320°F peak	250°C/482°F	Surface temperature not to exceed 80°C/176°F to maintain cladding bond strength
Lower service temp	-80°C/-112°F	0°C/32°F	Informal testing indicates T-FIT Clean can operate at ~-195°C/383°F
Compression/recovery	Excellent	Very poor	Crosslinked nature of T-FIT Clean prevents permanent deformation when compressed
Fungal resistance	None after 28 days	Test not found	According to ASTM G21 - 15

Exclusion of Liability

Any information contained in this document is, to the best of the knowledge and belief of Zotefoams plc and of Zotefoams Inc. (together herein referred to as ZOTEFOAMS), accurate. Any liability on the part of ZOTEFOAMS or any subsidiary or holding company of ZOTEFOAMS for any loss, damage, costs or expenses directly or indirectly arising out of the use of such information or the use, application, adaptation or processing of any goods, materials or products described herein is, save as provided in ZOTEFOAMS' conditions of sale ("Conditions of Sale"), hereby excluded to the fullest extent permitted by law. Where ZOTEFOAMS' goods or materials are to be used in conjunction with other goods or materials, it is the responsibility of the user to obtain from the manufacturers or suppliers of the other goods or materials all technical data and other properties relating to those other goods or materials. Save as provided in the Conditions of Sale no liability can be accepted in respect of the use of ZOTEFOAMS' goods or materials in conjunction with any other goods or materials.

Where ZOTEFOAMS' goods or materials are likely to come into contact with foodstuffs or pharmaceuticals, whether directly or indirectly, or are likely to be used in the manufacture of toys, prior written confirmation of compliance with relevant legislative or regulatory standards for those applications may be requested from ZOTEFOAMS, if appropriate. Save as provided in the Conditions of Sale no liability can be accepted for any damage, loss or injury directly or indirectly arising out of any failure by the user to obtain such confirmation or to observe any recommendations given by or on behalf of ZOTEFOAMS.

ZOTEFOAMS MAKES NO WARRANTIES EXPRESS OR IMPLIED, EXCEPT TO THE EXTENT SET OUT IN THE CONDITIONS OF SALE, AND HEREBY SPECIFICALLY EXCLUDES ANY IMPLIED WARRANTY OF MERCHANTABILITY OR FITNESS FOR A PARTICULAR PURPOSE WITH RESPECT TO ANY GOODS, MATERIALS OR PRODUCTS DESCRIBED HEREIN.

Zotefoams plc Management systems are covered by the following:



Quality
FM 01570
ISO 9001:2015



Safety
OHS 52538
ISO 45001: 2018



Environment
EMS 36270
ISO 14001:2015

Zotefoams plc

675 Mitcham Road
Croydon, Surrey
CR9 3AL, United Kingdom
Tel: +44 (0) 20 8664 1600
Email: t-fitsales@zotefoams.com

T-FIT Insulation Solutions India Private Limited

810 Shapath V, S.G. Highway
Ahmedabad, Gujarat, 380015
Tel: +91 (0) 7433946464
Email: t-fitindia@zotefoams.com

Zotefoams T-FIT Material Technology (Kunshan) Co., Ltd

181 Huanlou Road, Development Zone,
Kunshan City, Jiangsu Pr. China 215333
Tel: +86 (0) 512 5012 6001-8001
Email: t-fitchina@zotefoams.com

Zotefoams Inc.

55 Precision Drive
Walton KY, 41094 USA
Tel: +1 (0) 859 371 4025
Free: (800) 362-8358 (US Only)
Email: t-fitusa@zotefoams.com

T-FIT® and ZOTEK®
are registered trademarks
of Zotefoams plc.
All rights reserved.
Issue 1
Revision 1

If you would like more information visit our website www.zotefoams.com

AZOTE® / **ZOTEK®** / **T-FIT®** / **MuCell®**

